



ENTEGRA

COACH®

Odyssey

Serial #: 1JSLECBM9V1EB8107
 Model: 24B ODYSSEY MHC
 VIN#: 1FDDXE4FN5VDD01658
 Model Year: 2027 Dealer Name: NATIONAL INDOOR RV CENTERS
 4640 NEXUS WAY
 NORTH LAS VEGAS, NV 89115



Standard Equipment

THE FOLLOWING ITEMS ARE STANDARD ON THIS MODEL

- STANDARD EXTERIOR EQUIPMENT**
- Front E-450 chassis
 - GVWR - 14,500 lb.
 - GVWR - 22,000 lb.
 - 6-speed TorqShift® series transmission with overdrive
 - 21-amp alternator
 - Electric power steering
 - Power anti-lock brakes with power steering
 - 7.5-amp battery
 - 12V chassis battery
 - 55 gal. fuel tank
 - 11.5 gal. water tank
 - 11.5 gal. vacuum-bond laminated roof, floor and floor (R-5 max walls)
 - Bead-foam insulation (R-24 max roof, R-9 max floor, R-5 max walls)
 - One-piece, seamless, fiberglass roof
 - Leveling jack prep
 - Fiberglass exterior walls with vinyl graphics
 - Entrance door with industry's largest travel-view window
 - Electric-powered entrance step with integrated house battery compartment
 - Electric-powered entertainment compartment with light (select models)
 - Exterior LED HD Smart TV with (2) JBL® high-output, marine-grade exterior speakers
 - Roof ladder (248, 25R, 28M, 27U, 29V, 31F)
 - Prep for satellite dish
 - Cable TV hookup with RG-6 coax
 - Propane 20 lb. propane tank
 - Solar prep
 - 1,000W inverter
 - 12V house battery
 - 12V demand water pump
 - 30-amp electrical service
 - 12.2 gal. propane tank (41 lb.)
 - LP quick-connect hookup
 - LP quick-connect hookup
 - Mineralization drain system
 - Outside shower
 - Water filtration system

Optional Equipment

OPTIONAL EQUIPMENT INSTALLED ON THIS VEHICLE BY MANUFACTURER

- STANDARD INTERIOR EQUIPMENT**
- Smell driver and passenger seats
 - Remote-controlled, side-view mirrors
 - Tilt steering wheel
 - Dual side mirrors
 - Dual side mirrors
 - Electronic stability control
 - Traction control
 - Automatic emergency braking (AEB)
 - Power windows and door locks
 - Auxiliary start switch
 - Power and passenger airbags
 - Remote keyless cab entry
 - Custom-molded ABS surround in cab-over area
 - Overhead bunk with 750 lb. capacity and safety net
 - High-intensity, recessed LED lights
 - LED-ill. slideout fascia
 - Hardwood cabinet doors and drawer fronts
 - Interior entrance door grab handle
 - Interior command center
 - Recessed backdoor shades
 - 30,000 BTU auto-ignition furnace
 - EXK BTU Suburban On-Demand HW Heater
 - Electric fireplace (26M, 30Z)
 - EXK BTU Suburban On-Demand HW Heater
 - 30,000 BTU auto-ignition furnace
 - Rechargeable kitchen backseat
 - Rechargeable kitchen backseat
 - Queen-size bed with bedspread (27U)
 - Queen-size bed with bedspread (248, 25R, 28M)
 - Queen-size bed with bedspread (27U)
 - Queen-size bed with bedspread (248, 25R, 28M)
 - USB port in cabinet over bed (248, 25R, 28M)
 - Under-bed storage (select models)
 - Large wardrobes
 - Bunks with industry-exclusive, 300 lb. capacity each (31F)
 - Wall-mounted label holder in each bunk (31F)
 - Shower with decorative surround, glass door, skylight and light
 - Recessed stainless steel bathroom sink
 - Porcelain toilet with foot flush
 - Porcelain toilet vent in bathroom with wall switch
 - Carbon monoxide detector
 - Fire extinguisher

Base price	159,210.00
COASTAL DECOR	593.00
ALLOY GRAPHICS	N/C
USA STANDARDS	N/C
Z71 FORD E46 14500 158*	N/C
7.3L VDS307	N/C
CUSTOMER VALUE PACKAGE	11,260.00
HOUSE PACKAGE	N/C
HARDWOOD AUTO LEVELING	N/C
STANDARD HOUSE BATTERY	3,993.00
200W/ROOF MOUNTED SOLAR PANEL W/2ND HOUSE BATTERY	N/C
THEATER SEATING SOFA - TRADITIONAL	893.00
	743.00

UNIT TOTAL **176,582.00**

DEALER INSTALLED OPTIONS

Manufacturer's Suggested Retail Price

\$176,582.00

TOTAL AMOUNT DOES NOT INCLUDE STATE AND LOCAL TAXES OR LICENSE FEES. THE PRICE SHOWN ABOVE MAY OR MAY NOT BE REPRESENTATIVE OF THE ACTUAL SELLING PRICE OF SIMILAR RECREATIONAL VEHICLES IN YOUR AREA.

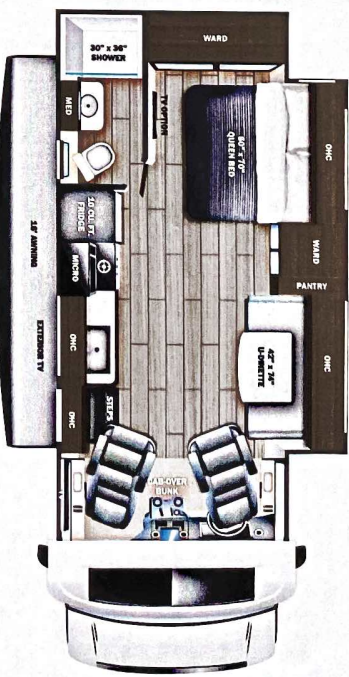

DIMENSIONS

Exterior height: 140.00"
 Exterior width: 100.00"

CAPACITIES

Fresh water tank (gals.) : 42.50
 Gray water tank (gals.) : 40.00
 Black water/toilet tank (gals.) : 31.00
 Propane (lbs.) : 41
 Propane (gals.) : 9
 Water heater (gals.) : 0.00

TIRES

Tire size (front) : LT225/75R16E
 Tire size (mid) : LT225/75R16E
 Tire size (rear) : LT225/75R16E

Some dimensions may be rounded and may vary from the actual dimensions
 Weights may be estimated calculations and may vary from the actual weight
 - refer to the vehicle weight labels for actual weights***
 Floorplans, features and specifications are subject to change without notice.

